

Quick Coupling Diagnostic Products

F Diagnostic



Increasing productivity and profitability are the key elements for a company to successfully compete in the world market today.

Reduced machine downtime during initial set-up, trouble shooting and maintenance procedures means increased productivity for you. That's why Parker provides the most complete line of hydraulic and pneumatic diagnostic equipment available today.

With Parker diagnostic equipment you can take critical measurements from your system with just a push of a button. Parker diagnostic instruments are designed to identify hard-to detect variations and peaks in pressures, temperatures and flow.

Parker diagnostic quick couplings and nipples allow quick

and easy access into hydraulic or pneumatic systems at remote test points without the use of tools.

Diagnostic nipples can be permanently installed in threaded test ports in hydraulic components such as valves, cylinders, accumulators, filters or pumps.

Diagnostic tube ends, used in conjunction with a 37° flare, bite type, or O-ring face seal tube fitting, will allow you to take pressure readings in your systems tubing and hose lines where threaded test ports may not currently be available.

From diagnostic nipples to digital monitoring equipment, Parker can provide the tools necessary to increase your productivity through reduced machine downtime.

Diagnostic Products



IntroductionF-2

Table of Contents.....F-3

Product Selection Guide.....F-4

The ServiceJunior™.....F-5

The SensoControl® Serviceman™

 GeneralF-6

 Schematic.....F-7

 Technical DataF-8

 Test Meter KitsF-9

 Components and Accessories.....F-14 - F-17

The SensoControl® Service Master

 GeneralF-10

 Schematic.....F-11

 Technical DataF-12

 Test Meter KitsF-13

 Components and Accessories.....F-14 - F-17

SensoControl Pressure Transducers F-15

SensoControl Flow Sensors.....F-16

Test Port Couplings

PD Series.....F-18 - F-20

 Dust Cap.....F-18

 CouplersF-19

 Nipples.....F-19 - F-20

 Tube End NipplesF-20

PDP SeriesF-21 - F-22

 Dust Cap.....F-21

 CouplersF-21

 Nipples.....F-22

EMA3 Series.....F-23

 Nipples.....F-23

 Gauge Adapter & UnionF-24

Transducer Adapters.....F-25

Flexible HoseF-25

PDFS Series - Fluid Sampling.....F-26

 CouplersF-26

 Nipples.....F-26

Ordering Information.....F-27

Diagnostic Products

Meter Selection Guide

Function	The Parker ServiceJunior	The Parker Serviceman	The Parker Service Master 450
Pressure Sensing	•	•	•
Flow Sensing		•1	•1
Temperature Sensing		•1	•2
Rotational Speed Sensing		•1	•
Auxiliary Sensing			•
Pressure Differential		•	•
Automatic Sensor Recognition	•	•	•
Auto Power Off	•	•	•
Battery Monitoring	•	•	•
Battery Type	AA (2 req'd)	Rechargeable Ni-MH	Rechargeable Ni-Cad
PC Compatible (Windows)		•1	•1
Minimum/Maximum Memory	•	•	•
Self Contained Memory			•
On-Line Data Transfer		•	•
Text Display (Lines)	2	2	8
Inputs	1	2	6
Data Points (Maximum in Memory)			250,000
Graphic LCD Display	•		•
Hydraulic Power Calculations			•
Volume Calculations			•

Notes: (1) Additional accessories are required to perform this function.
 (2) Transducers provide an ambient temperature signal, but additional temperature probes are required for more accurate temperature measurements.

Test Port Coupling Selection Guide

	Valving	Body Size	Material* Br SS S P	Locking Mechanism	Std. Seal Material	Temp Range**	Rated Pressure
Test Port							
PD Series	Flush Face	1/8"	• • •	Ball	Nitrile	-40° to +250° F	6000 PSI
PDP Series	Ball	1/8"	• • •	Ball	Nitrile	-40° to +250° F	6000 PSI
EMA3 Series	Poppet	1/8"	• • •	Threads	Nitrile/Fluorocarbon	-15° to +250° F	9000 PSI

* See Fluid Compatibility chart and/or consult factory for questions regarding proper material for specific applications.

CODE: Br = Brass; SS = Stainless Steel; S = Steel; P = Plastic

**Temperature Range for standard seal material.

Note: See the Specifications Table for PD and PDP Series for more information.

The new Parker ServiceJunior captures momentary pressure spikes that are “invisible” to normal liquid-filled gauges. That means the maximum pressure reading it delivers can be trusted as a much truer reflection of the system’s actual condition; so you can identify potential problems better and diagnose their causes faster. All readings are accurate to within +/-0.5%.

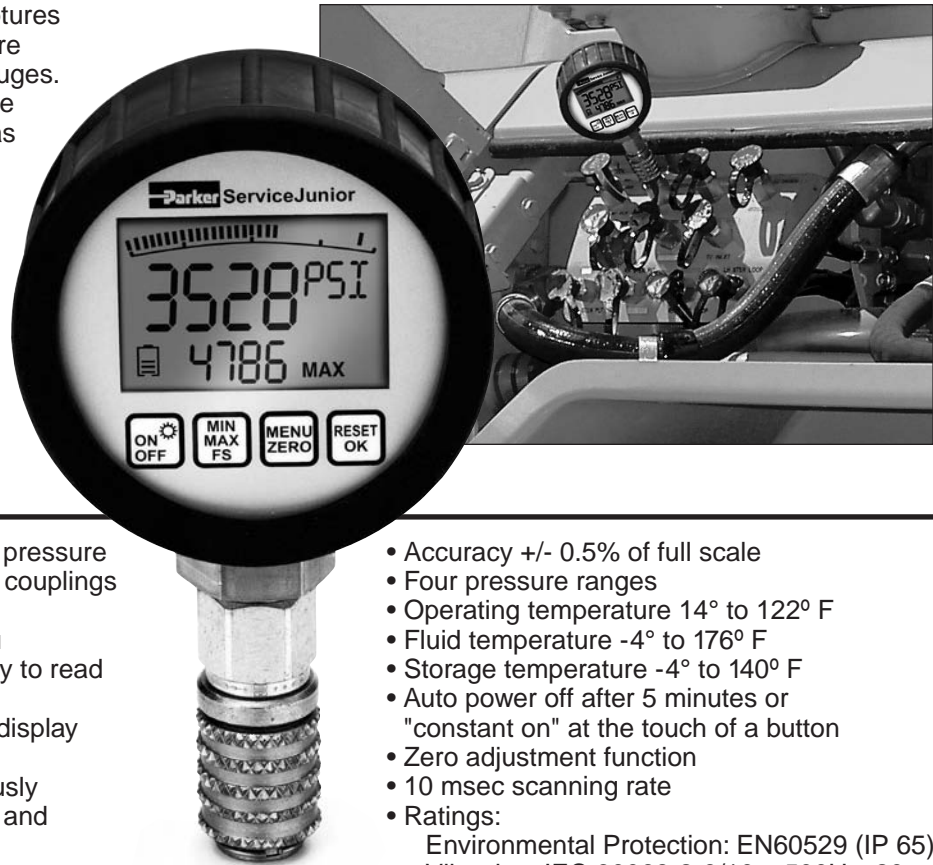

ServiceJunior Features

- Easy to connect and test system pressure using Parker Diagnostic test port couplings
- Robust, dirt resistant housing
- Simple to operate, four key menu
- Four digit backlit display with easy to read large 0.60" characters
- Minimum and maximum graphic display shows pressure peak
- Power status displayed continuously
- Can be used with most hydraulic and pneumatic media
- Measure PSI, bar, mPa, kPa with one gauge

- Accuracy +/- 0.5% of full scale
- Four pressure ranges
- Operating temperature 14° to 122° F
- Fluid temperature -4° to 176° F
- Storage temperature -4° to 140° F
- Auto power off after 5 minutes or "constant on" at the touch of a button
- Zero adjustment function
- 10 msec scanning rate
- Ratings:
Environmental Protection: EN60529 (IP 65)
Vibration: IEC 60068-2-6/10 – 500Hz: 20g
Shock: IEC 60068-2-29/50g 11 msec

Measuring Range	ServiceJunior with PD Coupler	ServiceJunior with EMA3 Coupler	ServiceJunior with 1/4" NPT Port	Overload Pressure	Resolution
-14.5 to 250 PSI (-1 to 16 bar)	SCJR-0250-PD	SCJR-0250-EMA	SCJR-0250-4MP	580 PSI	0.1 PSI
0 to 1500 PSI (0 to 100 bar)	SCJR-1500-PD	SCJR-1500-EMA	SCJR-1500-4MP	2,900 PSI	1 PSI
0 to 5800 PSI (0 to 400 bar)	SCJR-5800-PD	SCJR-5800-EMA	SCJR-5800-4MP	11,600 PSI	1 PSI
0 to 8700 PSI (0 to 600 bar)	SCJR-8700-PD ¹	SCJR-8700-EMA ²	SCJR-8700-4MP	17,400 PSI	1 PSI

NOTES: 1. PD Couplers rated to 6,000 PSI max. 2. EMA3 Couplers rated to 9,000 PSI max.

Accessories

Part Number	Description
PD240	PD Series diagnostic coupler
SCA-7/16-EMA-3	7/16 -18UNF-2B female to M16X2.0 EMA3 female swivel
SCJA-1/4	7/16 -18UNF-2B female to 1/4" NPT male adapter
PDH-19	19" PD Hose extension to be used with PD nipple interface
SMA3-400	16" hose assembly for EMA M16X2.0 interface
SCC-110	Storage case for one gauge and diagnostic adapters
SCC-150	Storage case for two gauges and diagnostic adapters

Hand-held Diagnostic Meter to Measure Pressure, Temperature, Flow and Rotational Speed for Hydraulic and Pneumatic Systems

- Easy operation
- Rugged design
- Compact Dimensions
- Two line display
- Auto sensor recognition
- MIN/MAX Memory
- Pressure differential
- External power supply
- Data output for PC



The Serviceman SCM-152 from Parker is a portable diagnostic measuring system – an excellent alternative to conventional mechanical pressure gages – a very rugged, durable test meter that can withstand even the most demanding environmental conditions.

The Serviceman meter uses the latest in sensor recognition technology which eliminates the need for meter adjustment. It's powered by a rechargeable Ni-MH battery system or a 120 volt external power supply for continuous operation

Using Serviceman software (compatible with Windows 98 and newer operating systems) the SCM-152 quickly interfaces with an Excel spread sheet.

The Serviceman field kit is the ideal set of diagnostic tools for maintenance and service personnel in the industrial, mobile and agricultural markets. These units help reduce downtime by recording the best preventative maintenance and diagnostic data available.

Parker Hannifin provides the most complete line of hydraulic and pneumatic diagnostic equipment available today. For more information contact the Quick Coupling Division or your local distributor.

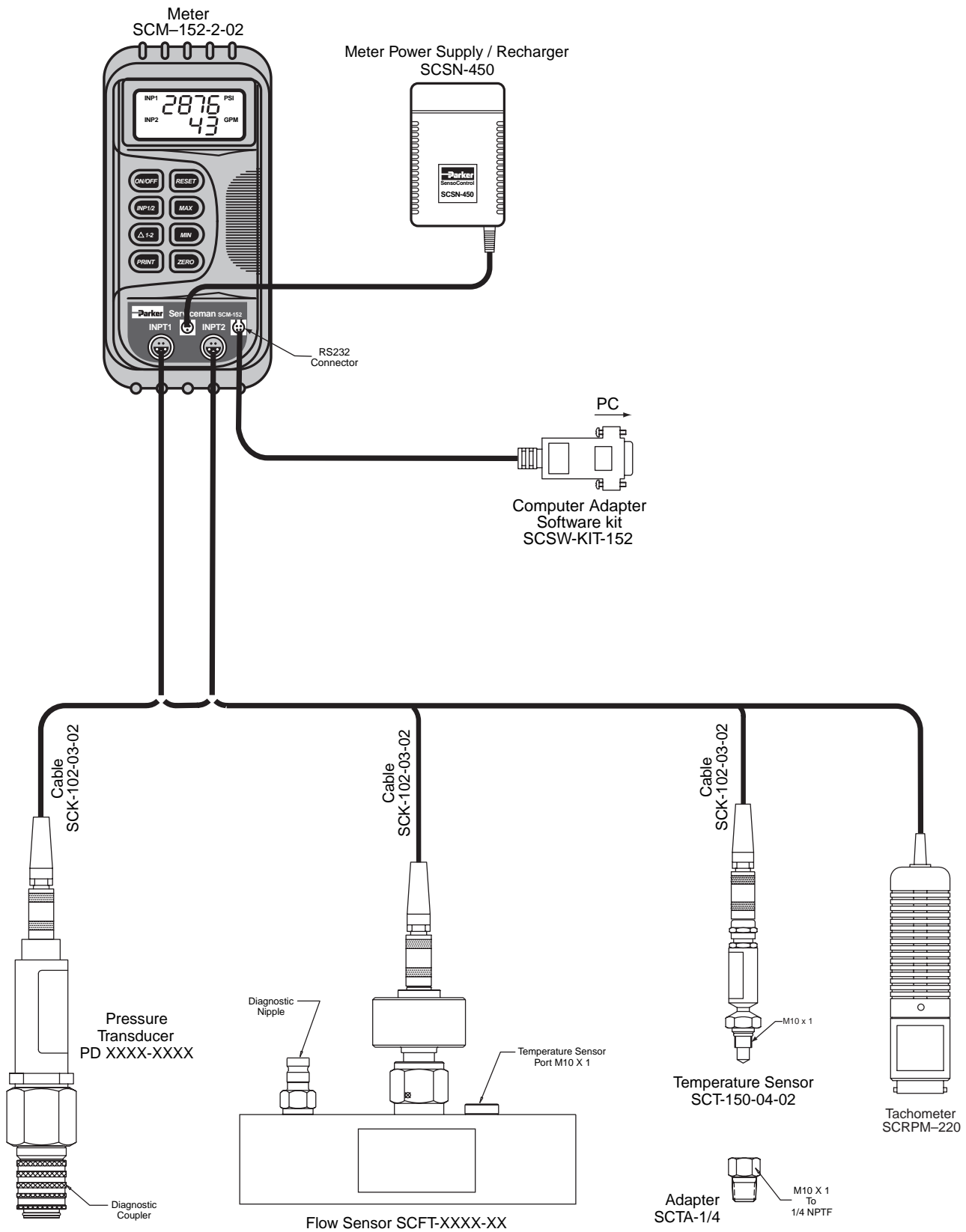

F Diagnostic

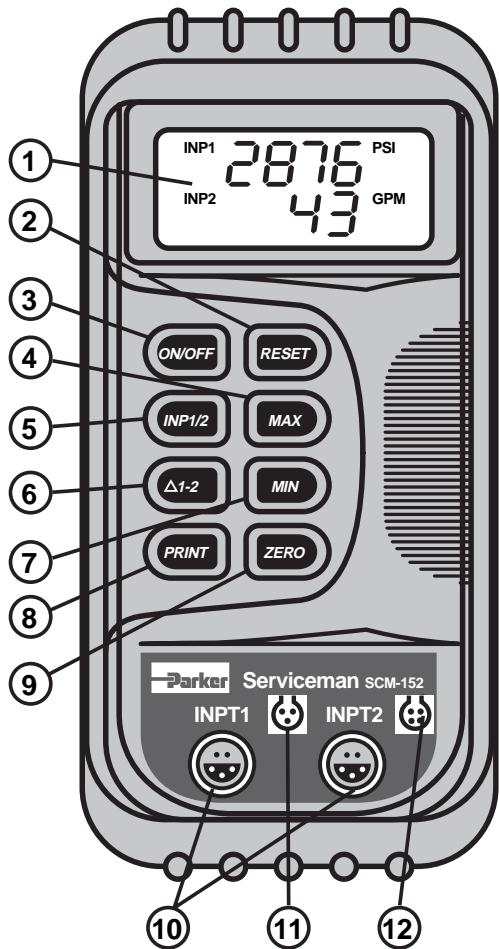

Function Descriptions

- 1 **Two Line Measurement Display**
- 2 **RESET** resets minimum and maximum values to zero
- 3 **ON/OFF** Switch
- 4 **MAX** displays maximum value since meter was last reset or turned on
- 5 **INP1/2** selects whether meter will display measurement from Input 1 or Input 2
- 6 **I1-I2** displays the differential value of Input 1 minus Input 2
- 7 **MIN** displays minimum value since meter was last reset or turned on
- 8 **PRINT** sends displayed measurements to PC or printer
- 9 **HOLD** resets display to zero
- 10 **Two Inputs** (5 pin)
- 11 **External Power Supply** Socket
- 12 **Data Output** via RS232 interface to transmit measured values to PC

Serviceman Technical Data

Meter

- 2 Line Display Shows Both Inputs
- 4 Digit LCD Text Display
- Display of Pressure, Temperature, Flow and Rotational Speed
 - Pressure in PSI and Bar
 - Temperature in °F and °C
 - Flow in GPM and l/min.
 - Rotational Speed in RPM

Housing

- ABS Plastic Housing
- Protective Rubber Cover
- Carrying Strap
- Integral Stand

Inputs

- Two 5-pin push-pull Inputs
- 0-3 Volts (R=470 kΩ)
- 12 Bit A/D Converter
- Automatic Sensor Recognition
- 2 ms Scanning Rate

Ambient Conditions

- Operating Temperatures
32°F to 122°F (0°C to 50°C)
- Storage Temperatures
-4°F to 140°F (-20°C to 60°C)

Output

- RS232 Interface to transfer measured values to a PC. The SCSW-KIT-152 software and adapter kit is required for data transfer to a PC.

Power Requirements

- 9 Volt Rechargeable Ni-MH Battery
- Recharge circuit for use with external power supply.
- 5 Hour Battery Life

F Diagnostic

Test Meter Kits



Kit Contents:

- CaseSCC-150
 - Serviceman MeterSCM-152-2-02
 - Transducers (Quantity 1 or 2)(See Below)
 - Cable (Quantity 1 or 2)SCK-102-03-02
 - Power Supply – Meter*SCSN-450
 - Instruction Manual*SCM-152-TM
- * Included with Serviceman Meter

**Code for Ordering
Serviceman Meter Kits:**

PDS3 - X - XX - XX **Transducer Pressure Range**
(Choose one or two)

Diagnostic Style

CODE	DESCRIPTION
2	PD Style
4	PDP Style
6	EMA3 Style (Female)

CODE	PRESSURE	COLOR
01	-14.5 – +235 PSI	Blue
06	0 – 870 PSI	Green
15	0 – 2175 PSI	Yellow
40	0 – 5800 PSI	Orange
60	0 – 8700 PSI	Red

Additional Transducers

Code for Ordering Separately:

PD XXXXXX - XXXX

Pressure Range

Diagnostic Style

CODE	DESCRIPTION
TA	PD Style
PTA	PDP Style
TEMA3	EMA3 Style (Female)

CODE	PRESSURE	COLOR
0100	-14.5 – +235 PSI	Blue
0600	0 – 870 PSI	Green
1500	0 – 2175 PSI	Yellow
4000	0 – 5800 PSI	Orange
6000	0 – 8700 PSI	Red

Flow Sensors

Code for Ordering Separately:

SCFT-XXXX - XXX

Diagnostic Style

Flow Range

CODE	FLOW RATE
0004	0.2 – 4 GPM (1 – 15 l/min)
0116	1 – 16 GPM (4 – 60 l/min)
0380	3 – 80 GPM (10 – 300 l/min)
5160	5 – 160 GPM (20 – 600 l/min)

CODE	DESCRIPTION
PD	PD Style
PDP	PDP Style
EMA	EMA Style

Hand-held Diagnostic Meter to Measure Pressure, Temperature, Flow and Rotational Speed for Hydraulic and Pneumatic Systems

- Easy operation
- Rugged design
- Large display
- Auto sensor recognition
- MIN/MAX Memory
- On-line operation
- Multiple sensor inputs
- Battery monitoring



The Parker Service Master meter is a state-of-the-art instrument with six channels for data collection. The ergonomically designed case and large automatic scaling LCD display make it very easy to use in even the most demanding environments.

They are the perfect tool to capture diagnostic measurements at remote locations. Able to measure pressure, temperature, flow and rotational speed simultaneously, the data can be gathered and stored on a PC for later analysis.

The SCM-450 provides 250,000 data points of storage. These measurements can easily be transferred to your PC via an RS232 interface and SensoWin™ 4.03 software which is compatible with Windows98 and newer operating systems.

As with all SensoControl equipment, the Parker Service Master offers the latest in sensor recognition technology, eliminating the need for individual sensor setup. It also allows you to program the individual inputs to accept other data collection formats, such as 4-20 ma, or 0-10 Volt.

Parker Hannifin provides the most complete line of hydraulic and pneumatic diagnostic equipment available today. For more information contact the Quick Coupling Division or your local distributor.

The SensoControl® Service Master
Measure and Document Flow, Pressure, Voltage, Current,
Temperature and Rotation Speed

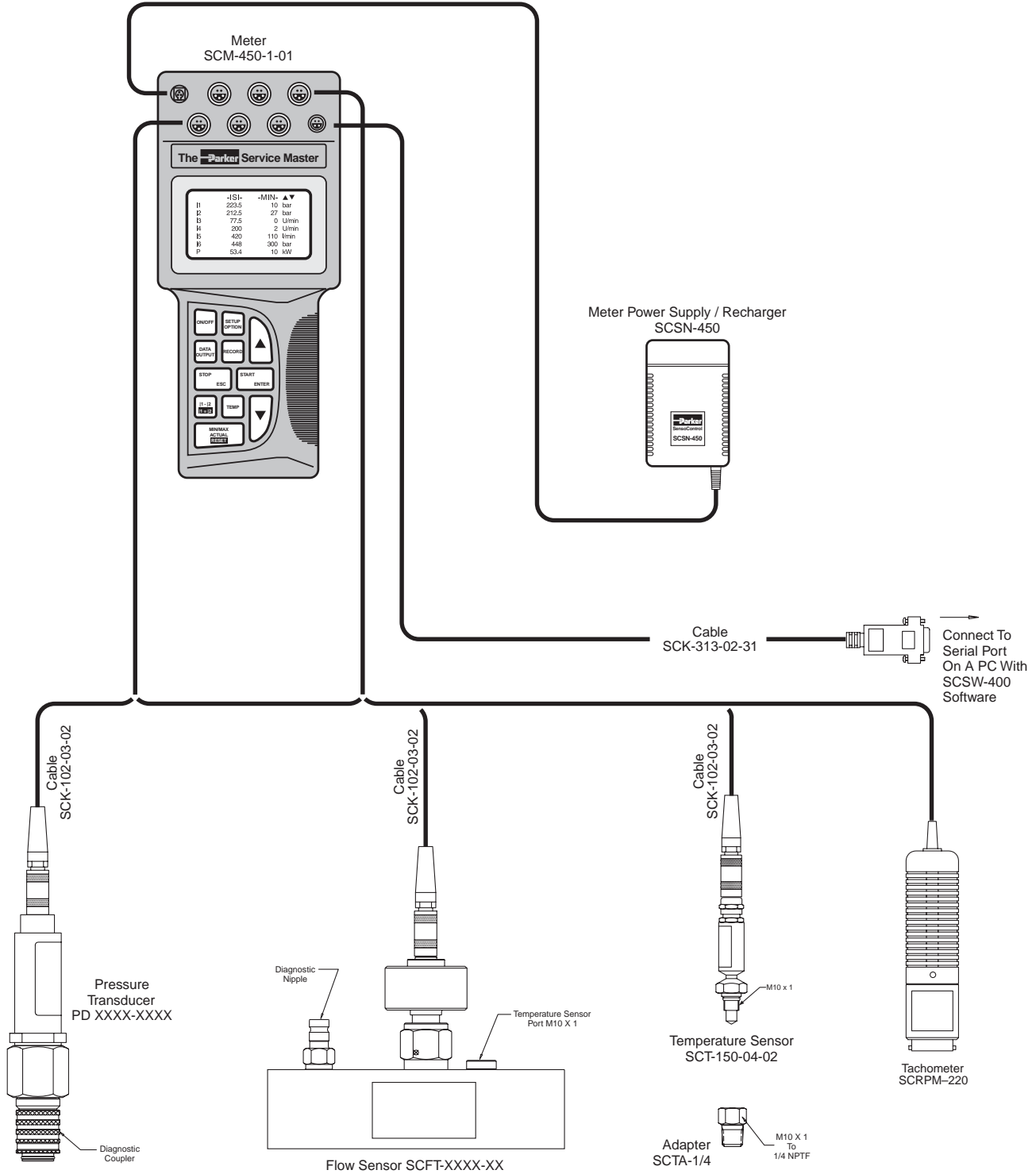

F Diagnostic

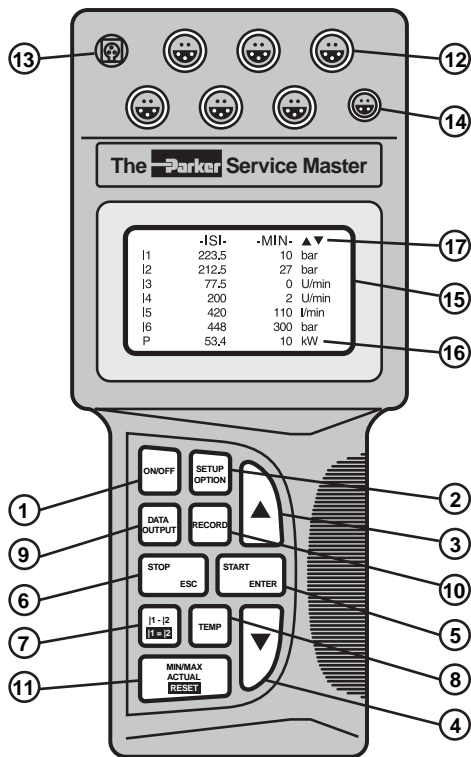

Function Descriptions

- 1 **ON/OFF** Turns meter on or off
- 2 **SETUP/OPTION** Change system settings
- 3/4 **ARROWS** Select line and function values
- 5 **START/ENTER** Change function values and start measurements
- 6 **STOP/ESC** Stop or terminate functions
- 7 **I1-I2** Differential value between input 1 and input 2.
- 8 **TEMP** Displays the measured temperature values for all channels
- 9 **DATA-OUTPUT** Displays output to PC, printer or graphic display
- 10 **RECORD** To record and store measurements
- 11 **MIN/MAX/ACTUAL** Displays the minimum, maximum and actual values. Reset deletes values
- 12 **INPUTS** Inputs for up to (6) sensors
- 13 **11-30 VDC** Input for external power supply and charging of internal battery
- 14 **DATA OUTPUT** RS232 port for connecting to the PC, printer, or external trigger module
- 15 **GRAPHIC LCD** Displays measured values, adjustment menus and graphics.
- 16 **ADDITIONAL LINE** Displays the power or flow runout values.
- 17 **STATUS LINE** Shows the designation of the measured value or the menu name.

Technical Data

Meter

- Digital LCD Text Display
 - 128x64 pixels
- Automatic Character Height Scaling
- Display of Pressure, Temperature, Flow and Rotational Speed
 - Pressure in PSI and Bar
 - Temperature in °F and °C
 - Flow in GPM and l/min.
 - Rotational Speed in RPM

Inputs

- Six, 5-pin push-pull style connectors
- Automatic Sensor Recognition
- 0-3 Volts (R=470 kΩ)
- 12 Bit A/D Converter
- 1 ms Scanning Rate (1-3 inputs)
- 2 ms Scanning Rate (4-6 inputs)

Functions

- Differential Value Measurement
- MIN/MAX Memory
- Online data transfer
- Battery level indicator
- Power calculation (display only)
- Flow run-out (display only)
- Auto power off

Output

- RS232 interface
- Adjustable baud rate up to 38400 BPS
- 8 data bits, 1 stop bit

Power Requirements

- Internal 7.2-volt rechargeable Ni-Cad battery
- Recharge circuit for use with external power supply.
- Operating time (Aprox. 5 hours)
- Excitation voltage (12-30 VDC)

Memory Functions

- Memory capacity 250,000 data points
- Memory used in 25,000 data point intervals
- Variable storage rate
- Variable measuring period up to 100 hours
- Manual and automatic triggering

Ambient Conditions

- Operating Temperatures 32°F to 122°F (0°C to 50°C)
- Storage Temperatures -4°F to 140°F (-20°C to 60°C)
- Protection class IP54

Housing

- Glass reinforced polyamide
- 11-Key tactile touch membrane
- EMC Protection
 - Electromagnetic interference (DIN/EN 50081, Part 1)
 - Immunity to emitted interference (DIN/EN 50082, Part 2)

Dimensions

- Length/Height/Width
 - 9.25 x 4.19 x 2.09
 - (235 x 106 x 52 mm)

Weight

- 1.2 lbs (700 grams)

F Diagnostic

Test Meter Kits



The Parker Service Master 450 Meter Kit

Kit Contents:

- | | |
|------------------------------------|---------------|
| Case | SC-690 |
| The Parker Service Master Meter | SCM-450-1-01 |
| Transducers (Quantity 2) | (See Below) |
| Transducer Cable, 10' (Quantity 2) | SCK-102-03-02 |
| Power Supply – Meter* | SCSN-450 |
| SensoWin Software 4.03 | SCSW-400 |
| Computer Interface Cable | SCK-313-02-31 |
| Operating Manual* | |

* Included with the Parker Service Master Meter

Code for Ordering the Parker Service Master Meter Kits:

PDSM 45 - X - XX - XX Transducer Pressure Range
(Choose two)

Diagnostic Style

CODE	DESCRIPTION
2	PD Style
4	PDP Style
6	EMA3 Style (Female)

Meter Style

CODE	PRESSURE	COLOR
01	-14.5 – +235 PSI	Blue
06	0 – 870 PSI	Green
15	0 – 2175 PSI	Yellow
40	0 – 5800 PSI	Orange
60	0 – 8700 PSI	Red

CODE	DESCRIPTION
45	The Parker Service Master 450 Meter

Additional Transducers

Code for Ordering Separately:

PD XXXXXX - XXXX

Pressure Range

Diagnostic Style

CODE	DESCRIPTION
TA	PD Style
PTA	PDP Style
TEMA3	EMA3 Style (Female)

CODE	PRESSURE	COLOR
0100	-14.5 – +235 PSI	Blue
0600	0 – 870 PSI	Green
1500	0 – 2175 PSI	Yellow
4000	0 – 5800 PSI	Orange
6000	0 – 8700 PSI	Red

Flow Sensors

Code for Ordering Separately:

SCFT-XXXX - XXX

Diagnostic Style

Flow Range

CODE	FLOW RATE
0004	0.2 – 4 GPM (1 – 15 l/min)
0116	1 – 16 GPM (4 – 60 l/min)
0380	3 – 80 GPM (10 – 300 l/min)
5160	5 – 160 GPM (20 – 600 l/min)

CODE	DESCRIPTION
PD	PD Style
PDP	PDP Style
EMA	EMA Style



Description	The Parker Serviceman	The Parker Service Master	Part Number
Serviceman Hand-held meter, 2 inputs (Includes SCSN-450 Power Supply)	•		SCM-152-2-02
The Parker Service Master Hand-held meter, 6 inputs, 250,000 data points (Includes SCSN-450 Power Supply)		•	SCM-450-1-01
Storage Case	•		SCC-150
Storage Case		•	SC-690
Power Supply 120 Volt AC	•	•	SCSN-450
Connection Cable Used between meter and sensors (3m length)	•	•	SCK-102-03-02
Extension Cable Used in series with connection cables (5m length)	•	•	SCK-102-05-12
Pressure Transducers Five measurement ranges	•	•	See page F-15
Flow Sensors Four measurement ranges	•	•	See page F-16
Temperature Sensor Used with Parker Flow Sensors or SCTA-1/4 Port Adapter (Requires standard connection cable)	•	•	SCT-150-04-02
Port Adapter Converts M10X1 to 1/4" male NPT thread	•	•	SCTA-1/4
Tachometer To measure rotational speed (0 to 10,000 RPM)	•	•	SCRPM-220
Contact Adapter For SCRPM-220 Tachometer	•	•	SCRPMA-001
Focus Adapter For SCRPM-220 Tachometer	•	•	SCRPMA-002
Diagnostic Test Hose Assembly Used with PD style Parker Transducers and diagnostic nipples	•	•	PDH-19
Voltage Adapter Used with auxiliary sensors		•	SCMA-VADC-600
Data Cable and Software To connect the Serviceman meter to a PC	•		SCSW-KIT-152
SensoWin 4.03 Software For data transfer from the Parker Service Master meter to a PC		•	SCSW-400
Data Cable Used between the Parker Service Master meter and a PC		•	SCK-313-02-31

F Diagnostic

F Diagnostic

Pressure Transducer Options

- Five measurement ranges:
Vacuum to 8,750 PSI
- Color coded for easy identification
- Corrosion resistant stainless steel housing
- Accuracy of .5% Full Scale (FS)
- Available with PD, PDP or EMA style diagnostic couplings



Transducer Technical Data



	PD ** -0100	PD *** -0600	PD *** -1500	PD *** -4000	PD *** -6000
Measuring Range (Pressure)	-14.5 to 235 PSI	0 to 870 PSI	0 to 2175 PSI	0 to 5800 PSI	0 to 8700 ⁽¹⁾ PSI
Color Code	Blue	Green	Yellow	Orange	Red
Measuring Range (Temp.)	-13°F to 221°F	-13°F to 221°F	-13°F to 221°F	-13°F to 221°F	-13°F to 221°F
Max. Overload Pressure	290 PSI	1450 PSI	3625 PSI	14500 PSI	14500 PSI
Output Signal (Volts)	-0.2 to 2	0 to 3	0 to 3	0 to 3	0 to 3
Hysteresis (% FS Typical)	0.1	0.05	0.1	0.08	0.05
Repeatability (%FS Typical)	0.08	0.13	0.13	0.1	0.1
Non-conformity (%FS)	0.25	0.2	0.2	0.28	0.25
Response Time	1 ms	1 ms	1 ms	1 ms	1 ms
Excitation Voltage	7-12 VDC	7-12 VDC	7-12 VDC	7-12 VDC	7-12 VDC

(1) Maximum Rated Pressure for PD Series Couplers is 6000 PSI.
(2) Maximum Rated Pressure for EMA Series Couplers is 9000 PSI.

“**” in the Part Number Represents:

- TA = PD Style
- PTA = PDP Style
- TEMA3 = EMA3 Style (Female)

Materials of Construction

TransducerStainless steel
DiaphragmStainless steel
Coupler . .Chromium-6 Free Plated steel
SealFluorocarbon

Temperature Range

Working-4° to 185°
Fluid-13° to 221°
Storage-40° to 257°

Output

Accuracy0.5% FS
Load2m ohms
Response time<1 ms
Output signal to noise0.1%FS
Resonant frequency100 KHz

Voltage Requirement

7 to 12 VDC excitation voltage
Permissible ripple±2% ss
Current requirement5 mA

Cable End (Pin Out)		
Pin	Mark	Wire Colors
1	P	yellow
2	T	white
3	+	brown
4	-	green
5	SK	grey



Special Note: All Parker SensoControl hand-held diagnostic meters are now equipped with the same 5-pin push-pull style connector ports. Accessories such as pressure sensors, temperature sensors, flow meters, tachometers and cables are all interchangeable between Serviceman and the Parker Service Master meters.

These flow sensors are a compact light-weight aluminum diagnostic tool capable of measuring pressure, temperature and flow from a single test point in a hydraulic system.

These flow sensors are designed to be used with a wide variety of hydraulic fluids. This design also minimizes the effect of viscosity changes. These units are manufactured from solid aluminum bar stock and are rated to 6000 PSI* and temperatures of 0°F to +350°F. They are available in four sizes with flow measuring ranges from 0.2 – 160 GPM.

Flow sensors are provided with a choice of PD, PDP or EMA style diagnostic ports and are designed to be used with Serviceman™ and the Parker Service Master equipment.



Flow Sensors Technical Data

- Pressure Rating*6000 PSI
** SCFT-7160 is rated to 5000 PSI*
- Fluid Temperature Range0°F to +350°F
- Ambient Temperature Range0°F to +120°F
- Media/CompatibilityPetroleum Based Fluids
(Contact factory for use with water based hydraulic fluids)
- Flow Measurement Accuracy±1.0% Actual Reading
- Voltage Input+7 to 12 VDC
(Supplied by SensoControl meter)
- Current Requirement6mA
- Response Time50 ms
- Viscosity Range11 to 50 cSt

Material Specifications

- Flow BlockAnodized Aluminum
- TurbineStainless Steel
- BearingsStainless Steel
- Seal MaterialNitrile
- Electrical Connection5 Pin Push-Pull Style

How to Order

Measuring Range	Flow Sensor with PD Nipple	Flow Sensor with PDP Nipple	Flow Sensor with EMA Nipple	Inlet/Outlet Port Configuration	Length inches	Height inches	Width inches
0.2 – 4 GPM (1 – 15 l/min)	SCFT-0004-PD	SCFT-0004-PDP	SCFT-0004-EMA	3/4-16 ORB	5.35	4.61	1.46
1 – 16 GPM (4 – 60 l/min)	SCFT-0116-PD	SCFT-0116-PDP	SCFT-0116-EMA	1 1/16-12 ORB	7.48	5.12	2.44
3 – 80 GPM (10 – 300 l/min)	SCFT-0380-PD	SCFT-0380-PDP	SCFT-0380-EMA	1 5/16-12 ORB	7.48	5.28	2.44
5 – 160 GPM (20 – 600 l/min)	SCFT-5160-PD	SCFT-5160-PDP	SCFT-5160-EMA	1 5/8-12 ORB	8.35	5.91	2.44

Special Note

All Parker SensoControl hand-held diagnostic meters are now equipped with the same 5-pin push-pull style connector ports. This means accessories such as pressure sensors, temperature sensors, flow meters, tachometers and cables are all interchangeable between the Serviceman and the Parker Service Master meters.



Temperature Sensor

for Serviceman and the Parker Service Master. Can be used with Parker flow sensors or with an SCTA-1/4 port adapter. Accuracy: ±1.5% Full scale Temperature range: -13°F to 257°F (-25°C to 125°C)

Part Number
SCT-150-04-02



SCRPM Tachometer

for Serviceman and the Parker Service Master Meters. Displays a precision measurement of rotational speed. 5-pin push-pull style connector.

Part Number
SCRPM-220

Technical Data

Measuring Range	.20 – 10,000 RPM
Measuring Distance	.0.1 – 19.5 in
Accuracy	.0.5% FS
Excitation Voltage	.7 – 9 VDC
Output Signal	.0 – 3 VDC
Resolution	.5 RPM

Tachometer Adapters

Contact Adapter for belt drive/wheel.

Part Number
SCRPMA-001

Focus Adapter for confined areas.

Part Number
SCRPMA-001



Voltage Adapter

for use with Auxiliary Sensors to the Parker Service Master. Input: 0 - 20 MA or 0 - 10 VDC Accuracy: 0.25% FS

Part Number
SCMA-VADC-600



5 pin to 5 pin Cables

Flow sensor, transducer and temperature probe cables for both Serviceman and the Parker Service Master.

Length	Part Number
10 ft (3 m)	SCK-102-03-02
Extension Cable	
16.4 ft (5 m)	SCK-102-05-12

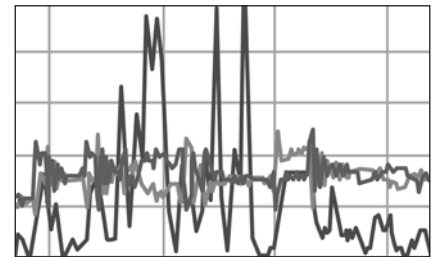

SensoWIN™ 4.03 Software

for data transfer from the Parker Service Master Meter to a PC (Windows 98 and newer).

Part Number
SCSW-400



Data Cable/Software

for use between the Serviceman Meter and a PC (Windows 98 and newer).

Part Number
SCSW-KIT-152



Applications

PD Series couplings provide easy connection for mechanical gauges or specialized diagnostic equipment like SensoControl®.

Typically, PD or BPD nipples are permanently mounted in the system at threaded test ports, in rigid tubing or in hose assemblies. PD couplers are attached to test instruments.

Couplers align to the mating nipples without threading. This allows gauges, transducers and other test equipment to be snapped into place without difficulty.

Note: Protective dust plugs and caps play a crucial role in the life of a quick coupling and no purchase of a hydraulic quick coupling is complete without the selection of an appropriate dust plug and cap. See pages noted in Table of Contents for dust plugs and caps for the Parker full line of hydraulic couplings.

Features

- Flush-face poppet valves minimize air inclusion and spillage, provide easy-to-clean surfaces, and help to prevent contamination.
- Grip-tight knurled sleeves help to make connecting and disconnecting easy, even while wearing gloves.
- Nipples are machined from high tensile steel for strength to withstand 6000 PSI continuous operating pressure. BPD nipples offer features similar to the standard steel PD nipples with the added feature of a brass body.
- PD nipples are designed to meet or exceed SAE J1502 and ISO 15171-1 design and performance specifications.
- End connections include pipe, O-ring, metric thread, bulkhead, 37° Flare, ORFS and bite-type.

Ordering information

Coupler/Nipple Material
<ul style="list-style-type: none"> • Prefix "B" for Brass body • Prefix "SS" for Stainless Steel body • Standard body material is Steel

Optional Seals Suffix*				
No suffix is required when ordering products with the standard Nitrile seals. When specifying an optional seal, refer to the following chart to determine the appropriate suffix.**				
Coupling Series	Ethylene Propylene	Fluoro-carbon	Neoprene	Perfluoro-elastomer
PD Series	W	Y	Z	
PDP Series	W	Y	Z	

*To select proper seal materials, see Fluid Compatibility Chart in Appendices section, or contact your Parker Quick Coupling Distributor.

**N/A = Not Available; STD = Standard (No Suffix Needed)

Specifications

Body Size	1/8			
	PD Coupler	PD Nipple	BPD Nipple	Assembly
Description	PD242	PD361	BPD343Y	—
Part Number	PD242	PD361	BPD343Y	—
Body Material (Steel)	Carbon Steel	High Tensile Steel	Brass	—
Rated Pressure (PSI)	6000	6000	300	6000
Temperature Range (STD Seals) Nitrile	-40°F to +250°F		-15°F to +400°F (Fluorocarbon)	-40°F to +250°F
Rated Flow (GPM)	—	—	—	0.8
Max. Recommended Flow (GPM)	—	—	—	4.0
Burst Pressure (PSI/Min)	23,000	40,000	—	17,000
Vacuum Data (Inches Hg)	27.5	27.5	27.5	27.5
Pressure Drop at Rated Flow (PSI) with 200 SUS Fluid	—	—	—	56
Spillage at 15 PSI (ml)-Assembly	0.1 per disconnect			
Air Inclusion (ml)-Assembly	0.02 per connect			
Connect Force-Assembly	41 Lbs. (100 PSI)			
Disconnect Force-Assembly	20 Lbs. (100 PSI)			

PD Series DUST CAP



Body Size (in.)	Dust Cap Part No.
1/8	PD6-285

Couplers

Female Thread

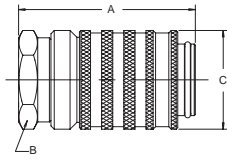

Body Size (in.)	Part No.	Female Thread NPTF	Female Thread ORB	Dimensions (in.)			Wt. (LB.) P/Piece
				Overall Length	Wrench Flats	Largest Diameter	
				A	B	C	
1/8	PD222	1/8-27	—	1.67	0.81	0.96	0.20
1/8	PD240	—	7/16-20	2.12	0.81	0.96	0.26
1/8	PD242	1/4-18	—	2.12	0.81	0.96	0.25
1/8	SSPD242Y**	1/4-18	—	2.12	0.81	0.96	0.25
1/8	PD260	—	9/16-18	2.12	0.81	0.96	0.24

Male Thread

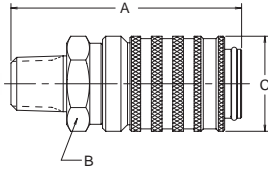

Body Size (in.)	Part No.	Male Thread NPTF	Male Thread ORB	Dimensions (in.)			Wt. (LB.) P/Piece
				Overall Length	Wrench Flats	Largest Diameter	
				A	B	C	
1/8	PD243	1/4-18	—	2.26	0.81	0.96	0.23

Nipples

Female Pipe Thread

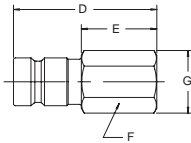

Body Size (in.)	Part No.	Thread Size NPTF	Overall Length	Exposed Length	Dimensions (in.)			Wt. (LB.) P/Piece
					Hex Size	Largest Diameter		
				D	E	F	G	
1/8	PD322	1/8-27	1.48	0.78	0.56	0.65	0.06	
1/8	PD342	1/4-18	1.63	0.93	0.75	0.87	0.12	

Male Pipe Thread

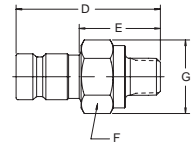

Body Size (in.)	Part No.	Thread Size NPTF	Overall Length	Exposed Length	Hex Size	Largest Diameter	Wt. (LB.) P/Piece
1/8	PD323	1/8-27	1.55	0.85	0.69	0.79	0.17
1/8	BPD323Y*	1/8-27	1.44	0.74	0.63	0.72	0.17
1/8	BPD343Y*	1/4-18	1.48	0.78	0.69	0.79	0.06
1/8	PD343	1/4-18	1.48	0.78	0.69	0.79	0.06
1/8	SSPD343Y**	1/4-18	1.48	0.78	0.69	0.79	0.06
1/8	PD363	3/8-18	1.50	1.13	0.81	0.96	0.09

Metric Thread

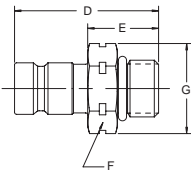

Body Size (in.s)	Part No.	Thread Size Metric	Overall Length	Exposed Length	Hex Size	Largest Diameter	Wt. (LB.) P/Piece
1/8	PD357	M10 x 1.0	1.80	1.10	0.69	0.79	0.17
1/8	PD3107	M16 x 1.5	1.54	0.84	0.88	1.01	0.08
1/8	PD3127	M18 x 1.5	1.60	0.90	0.94	1.08	0.09
1/8	PD3147	M20 x 1.5	1.50	0.80	0.75	0.87	0.07

Male Straight Thread

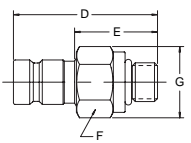

Body Size (in.)	Part* No.	Thread Size ORB	Overall Length	Exposed Length	Hex Size	Largest Diameter	Wt. (LB.) P/Piece
1/8	PD331	3/8-24	1.80	1.10	0.69	0.79	0.17
1/8	PD341	7/16-20	1.60	0.90	0.69	0.79	0.08
1/8	PD351	1/2-20	1.32	0.62	0.63	0.72	0.05
1/8	PD361	9/16-18	1.32	0.62	0.69	0.79	0.06

* Note: Add -6 to part number to include dust cap, for example PD343-6

* BPD designates brass body, Fluorocarbon seal standard

** SSPD designates 316SS body, Fluorocarbon seal standard

Nipples

Bulkhead Triple-Lok

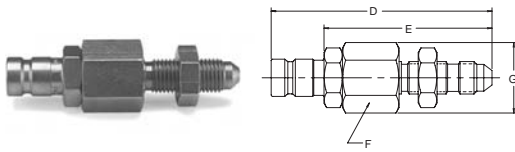

Body Size (in.)	Part No. Steel	Thread Size	Tube Size	Dimensions (in.)				Wt. (LB.) P/Piece	
				Overall Length	Exposed Length	Hex Size	Largest Diameter		
				D	E	F	G		
1/8	PD345	7/16-20	1/4	2.92	2.22	0.81	0.94	0.19	
1/8	PD355	1/2-20	5/16	2.92	2.22	0.81	0.94	0.19	
1/8	PD365	9/16-18	3/8	3.00	2.30	0.81	0.94	0.20	

Bulkhead Seal-Lok

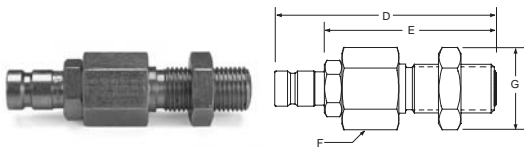

Body Size (in.)	Part No. Steel	Thread Size	Tube Size	Dimensions (in.)				Wt. (LB.) P/Piece	
				Overall Length	Exposed Length	Hex Size	Largest Diameter		
				D	E	F	G		
1/8	PD346	9/16-18	1/4	2.98	2.27	0.81	0.94	-	
1/8	PD366	11/16-16	3/8	3.08	2.37	1.00	1.16	-	
1/8	PD386	13/16-16	1/2	3.18	2.47	1.12	1.30	-	

Tube End Nipples*

Triple-Lok
PD — — BTX

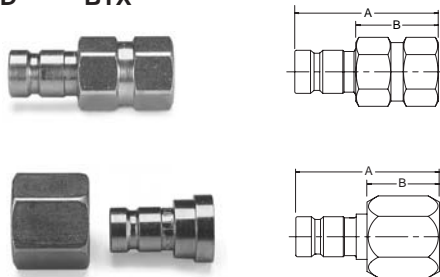

Body Size (in.)	Part No. Steel	Tube Size	Dimensions (in.)		Wt. (LB.) P/Piece	
			Overall Length	Exposed Length		
			A	B		
1/8	PD34BTX	1/4	1.64	0.94	0.10	
1/8	PD36BTX	3/8	1.66	0.96	0.09	
			A	B		
1/8	PD38BTX	1/2	1.17	0.47	0.12	
1/8	PD312BTX	3/4	1.39	0.69	0.27	

* Tube end nipples are designed to meet the performance standards of the tube or hose fitting connection, which may or may not meet SAE J1502 Standards.

Seal-Lok
PD — — BTL

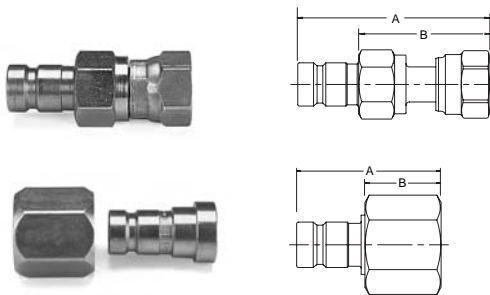

Body Size (in.)	Part No. Steel	Tube Size	Dimensions (in.)		Wt. (LB.) P/Piece	
			Overall Length	Exposed Length		
			A	B		
1/8	PD34BTL	1/4	2.18	1.48	0.12	
1/8	PD36BTL	3/8	2.30	1.60	0.14	
			A	B		
1/8	PD38BTL	1/2	1.57	0.83	0.13	
1/8	PD310BTL	5/8	1.16	0.46	0.19	

* Tube end nipples are designed to meet the performance standards of the tube or hose fitting connection, which may or may not meet SAE J1502 Standards.

Note: Add -6 to part number to include dust cap, for example PD343-6



Features

- Made to connect under pressure up to 6000 psi
- Grip-tight knurled sleeves help to make connecting and disconnecting easy, even while wearing gloves.
- Nipples are machined from high tensile steel for strength to withstand 6000 PSI continuous operating pressure.
- End connections include pipe, O-ring, 37° Flare and ORFS
- Durable Ball Valve Nipple.
- Coupler is unvalved to allow gauges and transducers to return to zero when disconnected.

Specifications

Body Size		1/8"		
Description	PDP Coupler	PDP Nipple	Assembly	
Body Material (Steel)	Carbon Steel	High Tensile Steel	—	
Rated Pressure (PSI)	—	6000	6000	
Temperature Range (STD Seals) Nitrile	-40°F to +250°F			
Connect Force-Assembly	6 Lbs (0 PSI - 6000 PSI)			
Disconnect Force-Assembly	7 Lbs (0 PSI - 6000 PSI)			

Coupler (connect-under-pressure)

Female Thread

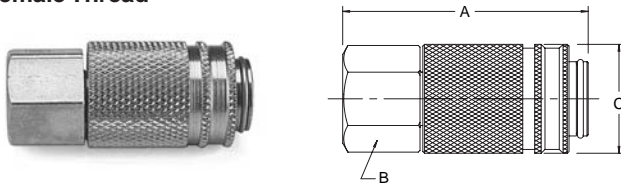

Applications

The PDP Series couplings provide easy connection for mechanical gauges or specialized diagnostic equipment like SensoControl.

Typically, PDP nipples are permanently mounted in the system at threaded test ports, in rigid tubing or in hose assemblies. PDP couplers are attached to test instruments.

Locking balls align the couplers to the mating nipples without threading, so gauges, transducers and other test equipment can be snapped into place without difficulty.

Parker's PDP Series couplings offer the advantages of PD couplings, but are designed to connect easily and quickly under full system pressure up to 6000 PSI (operating).

PDP couplers and nipples push to connect with a constant force of only six pounds. Then the coupler base is turned to open the valve and complete the connection. In the connected position, the coupler base blocks the retracting sleeve to prevent accidental disconnects.

Ordering information

Coupler/Nipple Material
Standard body material is steel.

Optional Seals Suffix*				
No suffix is required when ordering products with the standard Nitrile seals. When specifying an optional seal, refer to the following chart to determine the appropriate suffix.**				
Coupling Series	Ethylene Propylene	Fluoro-carbon	Neoprene	Perfluoro-elastomer
PD Series	W	Y	Z	
PDP Series	W	Y	Z	

*To select proper seal materials, see Fluid Compatibility Chart in Appendices section, or contact your Parker Quick Coupling Distributor.

**N/A = Not Available; STD = Standard (No Suffix Needed)

Body Size (in.)	Part No. Steel	Thread Size NPTF	Dimensions (in.)			
			Overall Length	Wrench Flats	Largest Diameter	Wt. (LB.) P/Piece
			A	B	C	
1/8	PDP242	1/4-18	2.15	0.81	0.96	—

PDP Series DUST CAP



Body Size (in.)	Dust Cap Part No.
1/8	PD6-285

Nipples*
(connect-under-pressure)

Male Pipe

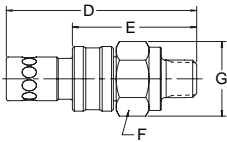

Body Size (in.)	Part No. Steel	Thread Size NPTF	Overall Length	Dimensions (in.)			Largest Diameter	Wt. (LB.) P/Piece
				Exposed Length	Hex Size	F		
			D	E	F	G		
1/8	PDP323	1/8-27	2.02	1.46	0.69	0.79	0.26	
1/8	PDP343	1/4-18	1.48	0.93	0.69	0.79	0.12	

Straight Thread

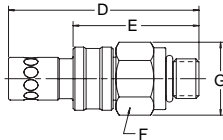

Body Size (in.)	Part No. Steel	Thread Size ORB	Overall Length	Dimensions (in.)			Largest Diameter	Wt. (LB.) P/Piece
				Exposed Length	Hex Size	F		
			D	E	F	G		
1/8	PDP341	7/16-20	2.06	1.50	0.69	0.79	0.12	
1/8	PDP361	9/16-18	1.48	0.93	0.69	0.79	0.07	

*Add -6 to part number to include dust cap.

Triple-Lok

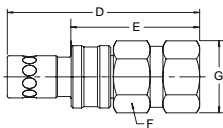

Body Size (in.)	Part No. Steel	Tube Size	Overall Length	Dimensions (in.)			Largest Diameter	Wt. (LB.) P/Piece
				Exposed Length	Hex Size	F		
			D	E	F	G		
1/8	PDP34BTX	1/4	2.11	1.55	0.69	.80	-	
1/8	PDP36BTX	3/8	2.13	1.57	0.69	.80	-	

Seal-Lok

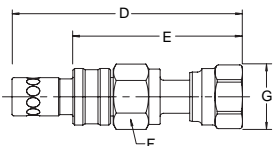

Body Size (in.)	Part No. Steel	Tube Size	Overall Length	Dimensions (in.)			Largest Diameter	Wt. (LB.) P/Piece
				Exposed Length	Hex Size	F		
			D	E	F	G		
1/8	PDP34BTL	1/4	2.65	2.09	.69	.80	-	
1/8	PDP36BTL	3/8	2.77	2.21	.81	.94	-	

F Diagnostic



Features

- Knurled sleeve allows simple twist-to-connect operation without the use of tools
- Rugged design allows connect-under-pressure operation up to 5800 psi
- Maximum rated working pressure of 9000 psi exceeds the requirements of most applications
- Integral threaded dust cap protects the test point from damage and contamination
- EMA fittings are machined from solid barstock and protected with Chromium-6 Free plating.
- Stainless steel springs for corrosion resistance
- Elastomeric interface and valve seals provide leak free operation
- Compact design and optional high pressure hose assemblies provide flexibility for tight space requirements

Applications

EMA couplings provide easy diagnostic connections for Parker SensoControl® equipment or mechanical gages. EMA test points are typically permanently plumbed into a fluid system at locations where pressure measurements are required for maintenance or testing. Integral pressure cap protects the test point from damage and prevents contamination of the fluid system. Proven twist-to-connect design allows the test points to be connected even when the system is in operation and the test points are pressurized. EMA's compact design and optional high pressure hose assemblies allow extra flexibility for the location of system test points.

Although designed primarily for diagnostic applications, EMA fittings and hose assemblies are ideal for a wide range of applications that require compact high pressure connections and limited flow rates.

Specifications

Body Size	1/8
Rated Pressure (PSI)	9000 PSI
Max Connect-Under-Pressure (PSI)	5800
Rated Flow (GPM)	0.8
Body Material	Chromium-6 Free Plated Steel
Seal Material (std.)	Nitrile/Fluorocarbon
Temperature Range (std. seals)	-15° to +250° F

Male Pipe Thread

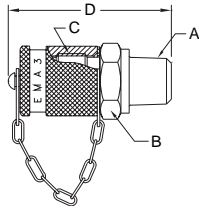

Part No.	Port Thread Size	Hex Size (mm)	Interface Thread Size	Overall Length	Wt. (LB.) P/Piece
	A	B	C	D	
EMA3/1/8NPT	1/8-27NPT	17	M16X2.0	1.81	0.15
EMA3/1/4NPT	1/4-18NPT	17	M16X2.0	1.98	0.16
EMA3/1/4NPT71	1/4-18NPT	17	M16X2.0	1.95	0.16

Stainless Steel

SAE Straight Thread

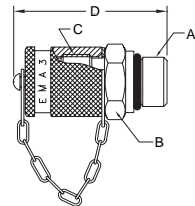

Part No.	Port Thread Size	Hex Size (mm)	Interface Thread size	Overall Length	Wt. (LB.) P/Piece
	A	B	C	D	
EMA3/7/16-20UNF-2A*	7/16-20UNF-2A	17	M16X2.0	1.88	0.15
EMA3/9/16-18UNF-2A*	9/16-18UNF-2A	19	M16X2.0	1.88	0.17

* O-Ring seal on port

Metric Straight Thread

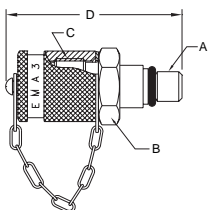

Part No.	Port Thread Size	Hex Size (mm)	Interface Thread Size	Overall Length	Wt. (LB.) P/Piece
	A	B	C	D	
EMA3/M8X1OR*	M8X1	17	M16X2.0	1.81	0.15
EMA3/10X1ED**	M10X1	17	M16X2.0	1.85	0.15
EMA3/12X1.5ED**	M12X1.5	17	M16X2.0	1.94	0.16
EMA3/14X1.5ED**	M14X1.5	19	M16X2.0	1.94	0.16

* O-Ring seal on port

** Molded seal on port

British Parallel Pipe

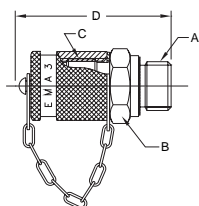

Part No.	Port Thread Size	Hex Size (mm)	Interface Thread Size	Overall Length	Wt. (LB.) P/Piece
	A	B	C	D	
EMA3/1/8ED**	1/8 BSPP	19	M16X2.0	1.77	0.15
EMA3/1/4ED**	1/4 BSPP	19	M16X2.0	1.94	0.16
EMA3/3/8ED**	3/8 BSPP	21	M16X2.0	1.94	0.16

** Molded seal on port



EMA Gauge Adapter

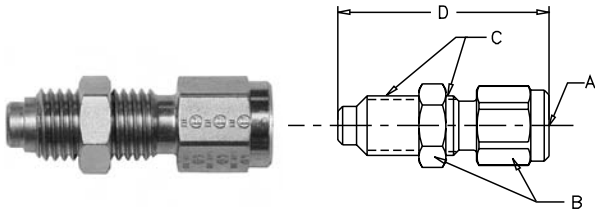

Part No.	Port Thread Size	Hex Size (mm)	Port Thread Size	Overall Length	Wt. (LB.) P/Piece
	A	B	C	D	
MAV1/4NPT-MA3	1/4-18NPT	19	M16X2.0	2.22	0.16
MAV1/4NPT-MA3-KM Includes Dust Cap	1/4-18NPT	19	M16X2.0	2.22	0.23

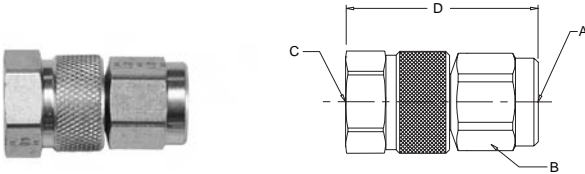

Part No.	Port Thread Size	Hex Size (mm)	Port Thread Size	Overall Length	Wt. (LB.) P/Piece
	A	B	C	D	
MAVMD1/4NPT-MA3	1/4-18NPT	19	M16X2.0	2.22	0.18

Union

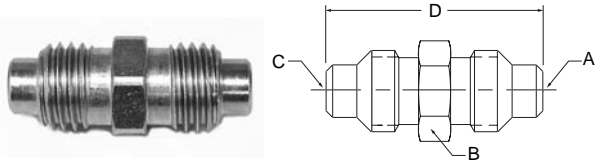

Part No.	Port Thread Size	Hex Size (mm)	Port Thread Size	Overall Length	Wt. (LB.) P/Piece
	A	B	C	D	
EMA3VS	M16X2.0	17	M16X2.0	1.65	0.11

F Diagnostic

Transducer Adapters 1/2-14BSPP Thread*

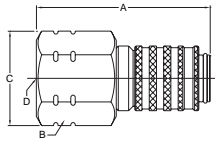

Part No.	Overall Length	Hex Size	Largest Diameter	Port Thread Size	Interface Thread Size	Wt. (LB.) P/Piece
	A	B	C	D	E	
PD288	2.52	1.19	1.38	1/2-14BSPP	-	0.35

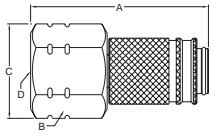
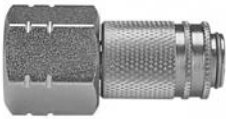

Part No.	Overall Length	Hex Size	Largest Diameter	Port Thread Size	Interface Thread Size	Wt. (LB.) P/Piece
	A	B	C	D	E	
PDP288	2.58	1.19	1.38	1/2-14BSPP	-	0.35

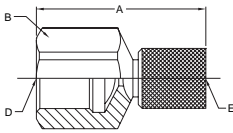
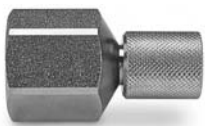

Part No.	Overall Length	Hex Size Metric	Largest Diameter	Port Thread Size	Interface Thread Size	Wt. (LB.) P/Piece
	A	B	-	D	E	
SCA-1/2-EMA-3	2.07	27mm	-	1/2-14BSPP	M16X2.0	0.30

* Note: For old style M22X1.5 thread contact the division

Flexible Hose

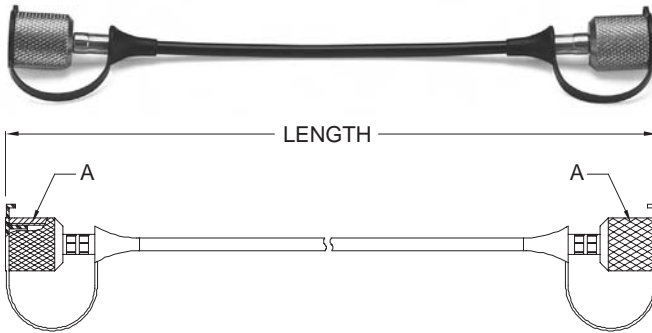

Part No.	Length (in.)	Length (mm)	Thread Size A
SMA3-200	7.90	200	M16x2.0
SMA3-400	15.75	400	M16x2.0
SMA3-800	31.50	800	M16x2.0
SMA3-2000	78.75	2000	M16x2.0
SMA3-4000	157.50	4000	M16x2.0

Note: Other lengths available upon request.
Maximum pressure rating for test hose is 9000 psi.



Features

These diagnostic fluid sampling products are designed to provide an easy access point for obtaining fluid samples. A permanently mounted test point eliminates the need to shut down or break lines when taking samples and reduces the chances of contamination. Fluid analysis is crucial in both engines and hydraulic systems as it can reveal problems with filtration and other internal components. Early detection can prevent costly repairs, unscheduled maintenance and production downtime. These fluid sampling nipples should be installed in either low pressure or return lines. For the most accurate monitoring, fluid samples should be constantly taken from the same location.

Specifications

Body Size (in.)	1/8
Rated Pressure (psi)	500
Temperature Range (std seals: Fluorocarbon)	-40° to +250°F
Seal material	Fluorocarbon

Couplers

Female Thread

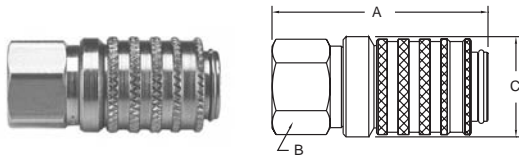

Body Size (in.)	Part No.	Female Thread NPTF	Female Thread ORB	Dimensions (in.)			Largest Diameter P/Piece
				Overall Length	Wrench Flats	Wt. (LB.)	
				A	B	C	
1/8	PDFS242	1/4-18	–	2.15	0.81	0.96	0.25

Nipples

Male Straight Thread

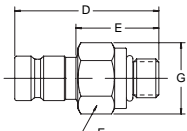

Male Pipe Thread

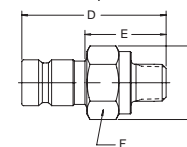

Body Size (in.)	Part No.	Thread Size ORB or NPTF	Thread Size METRIC	Dimensions (in.)				Largest Diameter P/Piece
				Overall Length	Exposed Length	Hex Size	Wt. (LB.)	
				D	E	F	G	
1/8	BPDFS341	7/16-20 ORB		1.60	0.90	0.69	0.79	0.08
1/8	BPDFS343	1/4-18 NPTF		1.48	0.78	0.69	0.79	0.06
1/8	PDFS-PROBE*		NA	–	–	–	–	–

Fluorocarbon seal is standard.

Dust Cap PD6-285 is recommended.

F Diagnostic

Diagnostic Products

When ordering Parker coupler bodies and nipples, please state the part number of each type of coupler body and each type of nipple desired. List coupler bodies and nipples as separate items rather than in combinations. Be sure to double check thread or hose sizes of items required.

Many of Parker's coupling products are available with unique non-standard options well suited to very specific applications. Examples of unusual end use applications might include: high temperatures (above 250° F), extremely caustic/corrosive solutions passing through the coupling, external/environmental corrosion situations, or other high wear and tear situations such as dragging the product along the ground. Please see the Fluid Compatibility Chart at the end of the catalog for a guide in selecting material for various media. It is always recommended that the Quick Coupling Division be contacted with any questions concerning specific product application needs.

Typically, a prefix or suffix is added to the base part number to specify a non-standard O-ring seal, or special option. The Optional Seals Suffix chart illustrates the designations.

Please Note: Certain couplings series have additional "Special Order Information" which should be referred to in ordering those products. If applicable to the product, "Special Order Information" is found next to the Features and Specifications charts.

Coupler/Nipple Material
<ul style="list-style-type: none"> • Prefix "B" for Brass body • Prefix "SS" for Stainless Steel body • Standard body material is Steel

Optional Seals Suffix*				
No suffix is required when ordering products with the standard Nitrile seals. When specifying an optional seal, refer to the following chart to determine the appropriate suffix.**				
Coupling Series	Ethylene Propylene	Fluoro-carbon	Neoprene	Perfluoro-elastomer
PD Series	W	Y	Z	
PDP Series	W	Y	Z	

*To select proper seal materials, see Fluid Compatibility Chart in Appendices section, or contact your Parker Quick Coupling Distributor.

**N/A = Not Available; STD = Standard (No Suffix Needed)

Diagnostic Products

Test Port Coupling-Selection Guide

	Valving	Body Size	Material* Br SS S P	Locking Mechanism	Std. Seal Material	Temp Range**	Rated Pressure
Test Port							
PD Series	Flush Face	1/8"	● ● ●	Ball	Nitrile	-40° to +250° F	6000 PSI
PDP Series	Ball	1/8"	●	Ball	Nitrile	-40° to +250° F	6000 PSI
EMA3 Series	Poppet	1/8"	● ●	Threads	Nitrile/Fluorocarbon	-15° to +250° F	9000 PSI

* See Fluid Compatibility chart and/or consult factory for questions regarding proper material for specific applications.

CODE: Br = Brass; SS = Stainless Steel; S = Steel; P = Plastic

**Temperature Range for standard seal material.

Note: See the Specifications Table for PD and PDP Series for more information.

SensoControl® diagnostic product's technical information subject to change.

